

## Student Conference on Presentation, Innovation & Evaluation : SCOPE KOREA

### SCOPE KOREA 2025 | Board of Judges

09:00 AM – 5:00 PM (KST), 6 September 2025 | COEX Convention Center, Seoul, South



#### Professor Kwon-Yul Ryu, Ph.D.

Professor, Department of Life Science, University of Seoul; former Department Chair (multiple terms) and Vice Dean. Ph.D. in Biochemistry from The Ohio State University; postdoctoral training at Stanford. Leads research in ubiquitin biology, proteostasis, and neurodegeneration, with recent work on astroglial responses and nano plastic neurotoxicity.



#### Professor Bumjo Oh, M.D., MPH, Ph.D.

Professor, Department of Family Medicine, SMG-SNU Boramae Medical Center, Seoul National University; Department Chair and Head since 2019. Holds M.P.H. in Genetic Epidemiology and dual B.S. degrees in Medicine and Microbiology from Seoul National University. Research focuses on occupational and environmental medicine, preventive health, and family medicine practice.



#### Associate Professor Jongchan Kim, Ph.D.

Associate Professor, Department of Life Sciences, Sogang University. Ph.D. (Vanderbilt) and postdoctoral/PI work at MD Anderson Cancer Center. Research spans cancer biology, non-coding RNAs, and deubiquitinases, including studies on MALAT1, TEAD/YAP pathways, and USP family enzymes.



#### Assistant Professor Hongik Hwang, Ph.D.

Assistant Professor, Department of Life Science, University of Seoul. Ph.D. in Biological Chemistry from MIT (2016). Research focuses on synaptic plasticity, learning and memory, and actin/cyclin-Y signaling, prior postdoctoral fellow at KIST Brain Science Institute.

## Student Conference on Presentation, Innovation & Evaluation : SCOPE KOREA

09:00 AM – 5:00 PM (KST), 6 September 2025 | COEX Convention Center, Seoul, South Korea

**SCOPE KOREA 2025** (Student Conference on Presentation, Innovation & Evaluation) is an international academic initiative designed to empower secondary school students with essential 21st-century competencies. Through a combination of academic assessment and innovation presentation, the program aims to foster critical thinking, creativity, and global communication.

*The Academic Challenge is designed to assess students' critical thinking and academic literacy through interdisciplinary reading and analysis.*

*The 9-Minute Pitch fosters innovation, communication, and global presentation skills aligned with the KSA (Knowledge–Skills–Attitudes) framework.*

This year's international round will be held in Seoul, South Korea, offering participants a unique platform to showcase their academic abilities and present innovative ideas on a global stage.

### 1. SCOPE Academic Challenge

A written academic assessment based on four English-language scholarly articles. The test is divided into two parts:

- **PART 1: Comprehension & Reasoning** (10 questions)
- **PART 2: Analytical Thinking** (10 questions)

The assessment is designed to evaluate students' ability to interpret, analyze, and apply academic knowledge across disciplines.

### 2. SCOPE 9-Minute: International Innovation Pitch Presentation

A dynamic competition where students present either an original innovation idea or a school-based project, supported by academic references. The presentation format includes:

- **Poster Presentation** (A3 size, editable Canva template provided)
- **Oral Presentation** (5-minute pitch + 4-minute Q&A, using 16:9 slides)

Participants may choose to join one or both competitions. Those who complete both the written assessment and the pitch presentation will receive a **Certificate of International Academic and Innovation Competency**.

### Event Details

- **Date & Time** : 09:00 AM – 5:00 PM, 6 September 2025 (KST)
- **Location**: COEX Convention Center, Seoul, South Korea

An awards ceremony will be held, and certificates will be given to all participants.

**Awards Ceremony**: Certificates and awards will be given to all participants, including special awards for top performers in each section.



## Certificate Ceremony



- **Top 10 Rankings Overall Highest Score Award:** Awarded to the participant with the highest overall score in the SCOPE KOREA 2025 assessments.
  - **Gold Medal:** Awarded to the participant with the highest overall score.
  - **Silver Medals:** Awarded to the participants with the second and third highest overall scores.
  - **Bronze Medals:** Awarded to the participants with the fourth and fifth highest overall scores.
  - **Certificates of Achievement:** Awarded to the participants with the sixth to tenth highest overall scores.
- **SCOPE-9M (SCOPE 9-Minute) Presentation Award:** Awarded to the participant who delivers the most effective and engaging SCOPE 9-Minute presentation.

## Rationale and Background

In the era of rapid global transformation driven by technology, innovation, and interdisciplinary knowledge, preparing youth to thrive in a competitive and interconnected world has become a critical educational imperative. The development of **higher-order thinking skills**, **academic literacy**, and **global communication abilities** is widely recognized as essential for learners in the 21st century<sup>1</sup>. Education systems today are shifting from content-heavy instruction to **competency-based education**, which emphasizes application, creativity, and problem-solving in real-world contexts<sup>2</sup>.

**SCOPE KOREA 2025** (Student Conference on Presentation, Innovation & Evaluation) is an international educational initiative designed to cultivate these competencies among secondary school students in Thailand. The program offers a structured and challenging platform where participants demonstrate their **academic reasoning**, **research interpretation**, and **innovation capacity** through high-impact academic and presentation-based competitions. The project emphasizes two core components that align with global educational frameworks and the **KSA Model (Knowledge–Skills–Attitudes)**<sup>3</sup>:

1. **An academic assessment** based on English-language scholarly articles, designed to evaluate students' comprehension, reasoning, and analytical thinking across disciplines.
2. **An international innovation pitch presentation**, titled *SCOPE 9-Minute*, where students present either an original idea or a school-based project supported by academic references. The format combines **poster presentation** and **oral communication**, simulating real-world academic and entrepreneurial experiences.

Beyond competition, the program also integrates **cross-cultural learning** through curated site visits in the Republic of Korea—broadening students' global perspective, enhancing their intercultural competence, and promoting leadership development in STEM and social innovation domains<sup>4</sup>.

By participating in SCOPE KOREA 2025, students not only enhance their academic and communication skills, but also gain formative international experiences that foster confidence, creativity, and a lifelong passion for learning and global citizenship.

<sup>1</sup>Trilling, B., & Fadel, C. (2009). 21st Century Skills: Learning for Life in Our Times. Jossey-Bass.

<sup>2</sup>Pellegrino, J. W., & Hilton, M. L. (Eds.). (2012). Education for Life and Work: Developing Transferable Knowledge and Skills in the 21st Century. National Academies Press.

<sup>3</sup>European Centre for the Development of Vocational Training. (2016). The role of KSA (Knowledge, Skills, Attitudes) in lifelong learning policy and practice. CEDEFOP.

<sup>4</sup>Deardorff, D. K. (2006). Identification and assessment of intercultural competence as a student outcome of internationalization. Journal of Studies in International Education, 10(3), 241–266.

The design of **SCOPE KOREA 2025** is firmly grounded in the internationally recognized **KSA model**, which promotes the balanced and integrated development of **Knowledge, Skills, and Attitudes** among learners. This educational philosophy reflects the global shift from **rote learning** to **competency-based education**, aligning with efforts to equip students with multidimensional capabilities for success in the 21st century<sup>1</sup>.

Under this model:

### **Knowledge (K): Building Academic Literacy**

Participants engage in academic assessment using scholarly articles in English, requiring them to read critically, comprehend complex texts, and apply concepts across disciplines. This process fosters deep intellectual engagement and exposes students to international academic standards, thereby enhancing their academic literacy and disciplinary insight<sup>2</sup>. It also prepares students for success in future higher education, particularly in English-medium or international environments.

### **Skills (S): Fostering 21st-Century Competencies**

Through the **SCOPE 9-Minute Innovation Pitch**, students are challenged to articulate ideas with clarity, support claims with academic references, and deliver persuasive oral presentations. The dual requirement of **poster presentation** and **oral pitch** mirrors real-world academic and professional scenarios, enhancing their ability to communicate, collaborate, think critically, solve problems, and use digital tools creatively<sup>3</sup>. These competencies are considered vital for leadership in both academic and entrepreneurial fields.

### **Attitudes (A): Nurturing Global Citizenship and Innovation Mindsets**

By participating in an international forum and engaging with peers from diverse cultural and educational backgrounds, students cultivate personal attributes such as confidence, responsibility, open-mindedness, and respect for diversity. The program nurtures an **attitude of inquiry, ethical participation, and a forward-thinking mindset**—shaping students not just as learners, but as **future changemakers** equipped to contribute meaningfully to society<sup>4</sup>.

In this way, **SCOPE KOREA 2025** is more than a competition; it is a comprehensive learning journey that integrates the KSA model at every level. It promotes **holistic growth**, aligning with global educational standards and setting a strong foundation for students' long-term academic, professional, and personal development.

<sup>1</sup>OECD. (2018). The Future of Education and Skills: Education 2030 – The OECD Learning Compass. Paris: OECD Publishing.

<sup>2</sup>Cummins, J. (2008). BICS and CALP: Empirical and theoretical status of the distinction. In B. Street & N. Hornberger (Eds.), Encyclopedia of Language and Education (Vol. 2, pp. 71–83). Springer.

<sup>3</sup>Saavedra, A. R., & Opfer, V. D. (2012). Learning 21st-century skills requires 21st-century teaching. Phi Delta Kappan, 94(2), 8–13.

<sup>4</sup>UNESCO. (2015). Global Citizenship Education: Topics and Learning Objectives. Paris: UNESCO.



# coex



## ASSESSMENT CRITERIA

### 1. SCOPE Academic Challenge

A written academic assessment based on four English-language scholarly articles. The test is divided into two parts:

- **PART 1: Comprehension & Reasoning** (10 questions)
- **PART 2: Analytical Thinking** (10 questions)

The assessment is designed to evaluate students' ability to interpret, analyze, and apply academic knowledge across disciplines.

### 2. SCOPE 9-Minute: International Innovation Pitch Presentation

A dynamic competition where students present either an original innovation idea or a school-based project, supported by academic references. The presentation format includes:

- **Poster Presentation** (A3 size, editable Canva template provided)
- **Oral Presentation** (5-minute pitch + 4-minute Q&A, using 16:9 slides)

## SCOPE KOREA 2025 : Student Conference on Presentation, Innovation & Evaluation

To ensure fairness, transparency, and academic rigor, the SCOPE KOREA 2025 Final Round adopts a clearly defined assessment framework composed of two equally significant components. Each component is evaluated based on predetermined criteria aligned with international standards of academic excellence, innovation competency, and 21st-century skills development.

### 1. SCOPE Academic Challenge

(20%)

The academic challenge is designed to assess students' intellectual abilities through a written examination derived from scholarly articles in English. The examination is structured into two parts, each measuring distinct cognitive domains:

Part	Assessment Focus	Description	Format	Weight
I	<b>Comprehension &amp; Reasoning</b>	Evaluates the ability to understand key arguments, interpret academic information, and make inferences	10 semi-objective questions (30 minutes)	10%
II	<b>Analytical Thinking</b>	Measures higher-order cognitive skills such as critical analysis, synthesis, and conceptual application	10 semi-objective questions (30 minutes)	10%

The SCOPE Academic Challenge is designed to evaluate students' academic literacy, reasoning, and analytical thinking using authentic academic content. Accordingly, the examination adopts the format of

#### Article-Based Multiple-Choice Questions with Reasoning (Article-Based MCQs with Reasoning)

Each test item is directly linked to a selected scholarly article and requires students to not only identify the correct response but also to provide a brief rationale or select the reasoning that best supports their chosen answer. This approach assesses both content comprehension and the student's ability to justify decisions based on evidence.

This assessment format encourages deeper engagement with academic texts and promotes essential 21st-century competencies such as critical reading, inferential thinking, and evidence-based reasoning.

## 2. SCOPE 9-Minute: International Innovation Pitch Presentation

(80%)

This component assesses students' ability to conceptualize, articulate, and defend original innovation ideas or research-informed projects. The presentation is comprised of two interrelated parts

Part	Component	Description	Format	Weight
I	Poster Presentation	Visual representation of the proposed innovation or project using academic structure and design	A3-sized poster	30%
II	Oral Presentation and Q&A Session	Verbal communication and critical engagement with the judging panel during a timed pitch session	5-minute oral pitch + 4-minute Q&A (16:9 slides)	50%

Language of Delivery: English

- **Academic Integrity:** Each presentation must include appropriate academic or scholarly referencing.
- **Assessment Dimensions:** Content originality, academic support, communication clarity, visual quality, and response to critical inquiry.

### Weight Distribution Overview

Evaluation Component	Percentage
SCOPE Academic Challenge	20%
- Part I: Comprehension & Reasoning	10%
- Part II: Analytical Thinking	10%
SCOPE 9-Minute: International Innovation Pitch	80%
- Poster Presentation	30%
- Oral Presentation & Q&A	50%
Total	100%

### SCOPE Academic Challenge

20%

The SCOPE Academic Challenge is a standardized written assessment designed to evaluate students' intellectual abilities, academic literacy, and critical thinking through a structured paper-based examination conducted in English. This component emphasizes fairness, objectivity, and alignment with international academic standards. The assessment comprises two equally weighted parts

10% | Part 1 : Comprehension & Reasoning

10 items (5 options : Time 30 minutes)

6 September 2025 (KST)

(Article-Based MCQs with Reasoning: English)

This section assesses students' ability to comprehend academic texts, interpret key arguments, and apply foundational knowledge across disciplines. Test items are based on selected scholarly articles and follow the format of Article-Based Multiple-Choice Questions with Reasoning (MCQ-R).

Participants are required not only to identify the most appropriate answer but also to provide a brief rationale for their choice, encouraging deeper engagement and evidence-based decision-making.

**Article 1 | Literature review as a research methodology: An overview and guidelines**

( Link : <https://www.sciencedirect.com/science/article/pii/S0148296319304564> )

**Article 2 | Nicotinamide mononucleotide (NMN) as an anti-aging health product – Promises and safety concerns**

( Link : <https://www.sciencedirect.com/science/article/pii/S2090123221001491> )

10% | Part 2 : Analytical Thinking

10 items (5 options : Time 30 minutes)

6 September 2025 (KST)

(Article-Based MCQs with Reasoning: English)

This section evaluates students' higher-order cognitive skills, including critical analysis, synthesis, and the application of academic knowledge within context. Questions are developed from academic research articles and require examinees to analyze information, draw conclusions, and assess implications using academic reasoning.

**Article 3 | Artificial intelligence and medical-engineering integration in diabetes management: Advances, opportunities, and challenges**

( Link : <https://www.sciencedirect.com/science/article/pii/S3050613124000068#fg0005> )

**Article 4 | Genetic engineering of *Saccharomyces boulardii*: Tools, strategies and advances for enhanced probiotic and therapeutic applications**

( Link : <https://www.sciencedirect.com/science/article/pii/S0734975025001491#f0010> )

**Note:** Although participants are grouped into different subject tracks (T1–T4), all students will complete the same set of academic articles and test content in this phase to ensure standardization and comparability across fields.

### Preparing for the Knowledge Paper-based Test

Participants are encouraged to review academic articles critically and practice constructing concise, evidence-based rationales for their answer choices. Time management is essential, as each section must be completed within the designated 30-minute limit. Familiarity with academic vocabulary, structure of scholarly articles, and logical reasoning will enhance performance. All test content is in English, and no external aids (such as dictionaries or translators) will be permitted during the exam.

### SCOPE 9-Minute: International Innovation Pitch

80%

The *SCOPE 9-Minute: International Innovation Pitch Presentation* is a core component of the SCOPE Korea 2025 program. This activity is designed to assess students' ability to conceptualize and communicate innovative ideas that integrate academic knowledge with real-world challenges. All participants will work individually to produce a visual and verbal presentation of their innovation.

The activity is conducted in English and consists of two main components:

1. Poster Presentation (A3-sized poster)
2. Oral Pitch Presentation ((16:9 slides) 5-minute oral pitch + 4-minute Q&A)

#### Objectives

- To enhance students' innovative thinking, research-based reasoning, and interdisciplinary application
- To foster global citizenship and awareness of societal and technological needs
- To develop presentation and communication skills in an international academic context

#### Subject Tracks

Students may base their innovation on one of the following four subject tracks, aligned with their academic interests:

- (T1) Medical & Health
- (T2) Science, Technology & Engineering
- (T3) Business & Management
- (T4) Social & Educational Studies

**Student Conference on Presentation, Innovation & Evaluation : SCOPE KOREA**

**TechEd Assessment Testing Office**

Website : [www.techeducationth.com/index.php/scopekorea/](http://www.techeducationth.com/index.php/scopekorea/)

Tel : +66 2 686 1202 (Office) Fax : +66 2 686 3433

E-mail: [eicd@th-ttis.com](mailto:eicd@th-ttis.com)



## Component 1: Poster Presentation

**Format:** One A1 poster designed using Canva

**Submission Method:** No file submission is required; organizers will download directly from Canva

**Editing Deadline:** 1 September 2025 (23:59 KST)

### Required Sections

- Title and Presenter Information
  - Title of the project
  - Full name of the presenter, affiliated school, and subject track
- (1) Background and Principle
  - Real-world problem, challenge, or opportunity addressed
  - Underlying principles or context of the innovation
- (2) Objective
  - Primary aim or goal of the innovation
  - Key questions the innovation intends to solve
- (3) Methods or Conceptual Model
  - Approach, process, or system used to develop the innovation
  - Diagrams or conceptual frameworks may be included
- (4) Challenges and Applications
  - Limitations, risks, or technical concerns
  - Real-world uses, potential impact, and scalability
- (5) Conclusion and Expected Impact
  - Summary of the expected outcomes
  - Broader relevance or contribution to society
- Optional QR Code
  - Link to a prototype, video demonstration, or extended document

## Component 2: Oral Pitch Presentation

**Format:** 5-minute individual presentation

**Visual Aid:** The same Canva-designed poster will be used during the oral pitch

**Editing Deadline:** 4 September 2025 (23:59 KST)

### Recommended Structure

- Introduction & Problem Statement (~1 minute)
- Innovation Concept & Objective (~1 minute)
- Methods or Core Mechanism (~1 minute)
- Challenges & Applications (~1 minute)
- Conclusion & Future Outlook (~1 minute)

The time limit will be strictly enforced. Students are encouraged to practice clarity, conciseness, and confident delivery.

### Assessment Criteria

Component	Criteria	Description	Weight
I. Poster Presentation	Content Originality	The project demonstrates creativity, innovation, and potential for development or real-world application.	10%
	Academic Support & Referencing	Use of credible academic sources, appropriate referencing, and clear linkage between ideas and evidence.	10%
	Visual Design & Structure	Clear layout, professional formatting, and logical organization aligned with academic presentation norms.	10%
II. Oral Presentation & Q&A	Verbal Communication & Delivery	Fluent and confident delivery, clear articulation, and appropriate use of English for academic presentation.	10%
	Depth of Understanding & Reasoning	Demonstrates deep understanding, coherent arguments, and critical thinking supported by evidence.	15%
	Response to Critical Inquiry (Q&A)	Responds effectively to questions with sound reasoning, clarity, and academic rigor.	15%
	Slide Quality & Academic Clarity	Slides are well-designed, relevant, and support the content with academic accuracy and visual balance.	10%

### Platform and Tools

- All students are required to use **Canva** ([www.canva.com](http://www.canva.com)) to prepare both their poster and presentation material.
- Participants do not need to upload any files. Organizers will access and download designs from Canva directly.
- Edits can be made on the Canva platform until the specified deadlines.

## Key Schedule

6 September 2025 | COEX Convention Center, Seoul, South Korea

Time		Activity	Location
09.00 - 09.20	20 minutes	Preparation and Project Introduction Session	COEX Convention Center, Seoul, South Korea
09.20 - 10.20	1 hours	<b>SCOPE Academic Challenge</b> PART 1: Comprehension & Reasoning (10 questions) PART 2: Analytical Thinking (10 questions)	
10.20 - 10.30	10 minutes	Break Time	
10.30 - 12.00	1 hours 30 minutes	<b>SCOPE 9-Minute: International Innovation Pitch</b> <ul style="list-style-type: none"> <li>Poster Presentation</li> <li>Oral Pitch Presentation</li> </ul>	
12.00 - 13.00	1 hours	Networking Lunch (Korean Cuisine)	COEX Convention Center, Seoul, South Korea
13.00 - 13.30	30 minutes	<b>Opening Ceremony</b>	
13.30 - 15.30	2 hours	<b>SCOPE 9-Minute: International Innovation Pitch</b> <ul style="list-style-type: none"> <li>Poster Presentation</li> <li>Oral Pitch Presentation</li> </ul>	
15.30 - 16.00	30 minutes	Break Time	
16.00 - 17.00	1 hours	<b>Certificate ceremony</b> <ul style="list-style-type: none"> <li><b>Top 10 Rankings Overall Highest Score Award:</b> Awarded to the participant with the highest overall score in the SCOPE KOREA 2025 assessments.</li> <li><b>SCOPE-9M (SCOPE 9-Minute) Presentation Award:</b> Awarded to the participant who delivers the most effective and engaging SCOPE 9-Minute presentation.</li> </ul>	South Korea
17.30		Special Dinner	

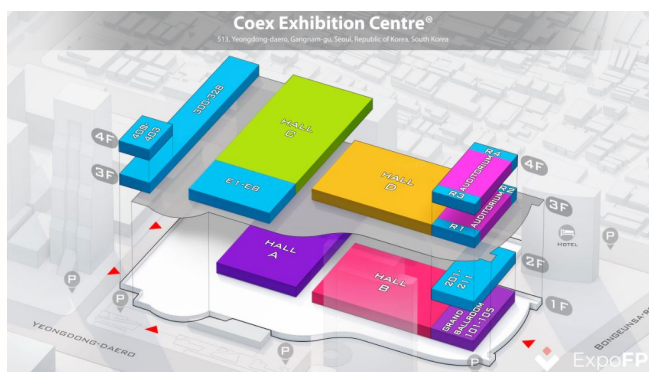
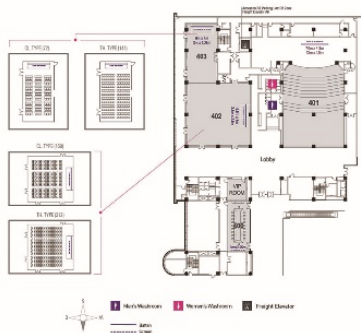



## SCOPE KOREA : Study Visit Program

“Connecting Academic Potential with Innovation, Institutions, and Culture”





## Overview of the Republic of Korea

### An Innovation-Driven Society Rooted in Education and Global Vision

The Republic of Korea (South Korea) is widely recognized as one of the world's most dynamic and innovative countries, combining rapid economic development with technological leadership and strong educational foundations. From the ashes of war in the 1950s, Korea has emerged as a global model for development, driven by long-term investment in education, research, and industrial modernization.

#### National Profile

- **Official Name:** Republic of Korea
- **Capital City:** Seoul
- **Population:** Approximately 52 million (as of 2024)
- **Language:** Korean (Hangul)
- **Political System:** Democratic Republic
- **Currency:** South Korean Won (KRW)
- **Human Development Index (HDI):** Ranked 19th globally (UNDP, 2023)

South Korea is a member of the **OECD (Organisation for Economic Co-operation and Development)**, **G20**, and is a key contributor to international education, technology, and trade. It is home to global brands such as Samsung, LG, Hyundai, and world-class institutions in healthcare, science, and education.

#### Economic and Technological Advancement

South Korea's economy ranks among the top 15 in the world by nominal GDP. It has transformed into an **export-driven knowledge economy** with high global rankings in R&D investment, innovation output, and digital infrastructure.

According to the **World Intellectual Property Organization (WIPO)**, South Korea consistently ranks among the top countries in the **Global Innovation Index**, placing 6th in 2023. The country is also a global leader in broadband access, 5G deployment, AI integration, and robotics research.

#### Reference:

- World Bank. (2024). *World Development Indicators*.
- World Intellectual Property Organization (WIPO). (2023). *Global Innovation Index*.
- United Nations Development Programme (UNDP). (2023). *Human Development Report*.

#### Education and Global Competency

Education plays a central role in Korea's national strategy for development. The country is known for its rigorous academic standards, high student performance in STEM subjects (as measured by OECD's PISA assessments), and significant investment in **higher education and educational technology (EdTech)**.

South Korea has one of the highest rates of tertiary education attainment in the world. Institutions such as Seoul National University, Yonsei University, KAIST, and POSTECH are internationally ranked and collaborate with top global partners.

#### Reference:

- OECD. (2023). *Education at a Glance*.
- Ministry of Education, Republic of Korea (MOE). (2023). *Korean Education Statistics*.
- UNESCO Institute for Statistics (UIS). (2023)

## Strategic Importance for SCOPE KOREA 2025

The selection of South Korea as the host country for SCOPE KOREA 2025 reflects its status as a model for **interdisciplinary innovation, academic excellence, and cultural influence**. Participants will not only experience Korea's academic and technological strengths but also gain insight into its successful integration of tradition with modernization.



### Asan Medical Center – Innovation in Medical Excellence

#### South Korea's No.1 Hospital and a Regional Leader in Smart Healthcare Innovation

Asan Medical Center (AMC), established in 1989, is the largest and most prestigious hospital in South Korea. Located in Seoul and affiliated with the University of Ulsan College of Medicine, AMC is a national leader in advanced healthcare, biomedical research, and clinical innovation. In the *World's Best Hospitals 2024* ranking published by **Newsweek and Statista**, AMC was ranked as the **No.1 hospital in South Korea**, and among the **top 50 hospitals globally**. It is widely recognized for its excellence in patient care, medical technology, and academic research.

#### Institutional Profile

- **Established:** 1989
- **Location:** Songpa District, Seoul, Republic of Korea
- **Affiliation:** University of Ulsan College of Medicine
- **Hospital Beds:** Over 2,700
- **Staff:** Approximately 11,000 personnel, including more than 1,600 physicians
- **Website:** <https://www.amc.seoul.kr>

#### Strategic Innovation and Medical Leadership

AMC integrates world-class clinical expertise with cutting-edge technologies to deliver high-quality patient care and lead in medical innovation. Key areas of excellence include:

- **Artificial Intelligence in Clinical Decision Support**  
AMC has developed AI-based diagnostic systems that enhance early detection and improve treatment outcomes in fields such as oncology and cardiology.
- **Smart Hospital Infrastructure**  
The hospital employs real-time digital systems, electronic health records, and IoT technologies to optimize operational efficiency and patient safety.

**Student Conference on Presentation, Innovation & Evaluation : SCOPE KOREA**

**TechEd Assessment Testing Office**

Website : [www.techeducationth.com/index.php/scopekorea/](http://www.techeducationth.com/index.php/scopekorea/)

Tel : +66 2 686 1202 (Office) Fax : +66 2 686 3433

E-mail: [eicd@th-tiis.com](mailto:eicd@th-tiis.com)

- **Robotic and Minimally Invasive Surgery**

Thousands of robotic-assisted surgeries are performed each year, with advanced applications in cancer, cardiac, and urological care.

- **Precision Medicine and Genomics**

As a pioneer in personalized medicine, AMC integrates genomic analysis into clinical practice to support individualized treatment strategies.

- **Global Research and Education**

Through the Asan Institute for Life Sciences and affiliated research centers, AMC conducts internationally acclaimed research in areas such as regenerative medicine, immunotherapy, and medical device development.

#### References:

- Newsweek & Statista. (2024). *World's Best Hospitals 2024 Rankings*.  
<https://www.newsweek.com/worlds-best-hospitals-2024>
- Asan Medical Center. (2024). *Hospital Overview*. <https://www.amc.seoul.kr>
- Kim, J. et al. (2023). *Smart hospital practices in South Korea: Integrating technology and care*. *Journal of Medical Systems*, 47(5).

#### Educational Relevance for SCOPE KOREA 2025 Participants

The study visit to Asan Medical Center provides students in the **Medical & Health Sciences** and **Science, Technology & Engineering** tracks with a rare opportunity to observe the convergence of healthcare, technology, and innovation. Key learning outcomes include:

- Exposure to AI-enhanced diagnostics, smart medical infrastructure, and patient-centered innovation
- Insights into hospital management and medical responses to aging populations
- Inspiration from Korea's leadership in smart hospital systems and global medical research
- Firsthand experience with how academic knowledge is applied in one of Asia's top healthcare institutions

The visit embodies the goals of SCOPE KOREA 2025 to foster academic excellence, interdisciplinary learning, and global health awareness.



รอบนานาชาติ | ศึกษาจากมหาวิทยาลัยชั้นนำต่างประเทศ

**YONSEI UNIVERSITY**  
มหาวิทยาลัยยอนเซ



**SCOPE KOREA**  
2025 STUDENT CONFERENCE ON PRESENTATION,  
INNOVATION & EVALUATION

#### ศึกษาจากมหาวิทยาลัยต่างประเทศ

มหาวิทยาลัยยอนเซ (YONSEI UNIVERSITY)

เป็นหนึ่งในมหาวิทยาลัยที่เก่าแก่และทรงเกียรติที่สุดของเกาหลีใต้  
ก่อตั้งขึ้นในปี 1885 มีชื่อเสียงด้านวิทยาศาสตร์สุขภาพและการ  
วิจัยทางการแพทย์ ติดอันดับมหาวิทยาลัยชั้นนำของเอเชียและ  
ของโลก

### Yonsei University (Sinchon Campus)

A Premier Institution of Higher Learning and Global Innovation in Education

Yonsei University, established in 1885, is one of South Korea's most prestigious and oldest private universities. Its **Sinchon Campus**, located in the heart of Seoul, is the flagship site of academic excellence, interdisciplinary research, and international engagement. Yonsei consistently ranks among the top universities in Asia and the world, and is renowned for its role in shaping Korea's modern education system, producing global leaders, and promoting knowledge-based innovation.

In 2024, Yonsei University was ranked among the **Top 100 Universities in the QS World University Rankings**, and is home to several research institutes, medical centers, and global partnership programs that reflect its commitment to academic rigor and social relevance.

#### Institutional Profile

- **Established:** 1885 (as Korea's first Western-style higher education institution)
- **Type:** Private Research University
- **Location:** Sinchon-dong, Seodaemun District, Seoul, Republic of Korea
- **Student Body:** Over 30,000 students (undergraduate and graduate)
- **International Programs:** Over 700 partner institutions worldwide
- **Website:** <https://www.yonsei.ac.kr>

#### Academic Strengths and Strategic Vision

Yonsei University's mission is rooted in "truth and freedom" and its educational philosophy promotes critical thinking, creative problem-solving, and global citizenship. Key areas of academic distinction include:

- **Interdisciplinary Research Excellence**

Yonsei is a leader in sustainability science, biomedical engineering, ICT, and innovation management. The university hosts globally recognized research centers and actively collaborates with top institutions across Asia, Europe, and North America.

- **Smart Campus and Digital Learning**

The Sinchon campus integrates advanced EdTech systems, AI-supported teaching, and smart classrooms to foster innovative pedagogy. The Yonsei Center for Teaching and Learning is a national model for faculty development and instructional design.

**Student Conference on Presentation, Innovation & Evaluation : SCOPE KOREA**

**TechEd Assessment Testing Office**

Website : [www.techeducationth.com/index.php/scopekorea/](http://www.techeducationth.com/index.php/scopekorea/)

Tel : +66 2 686 1202 (Office) Fax : +66 2 686 3433

E-mail: [eicd@th-ttis.com](mailto:eicd@th-ttis.com)



- **Global Education and Exchange**

Yonsei runs multiple international programs such as the **Global MBA**, **Underwood International College (UIC)**, and summer/winter schools, welcoming thousands of students from around the world each year.

- **Social Responsibility and Leadership Development**

The university emphasizes ethical leadership, service learning, and innovation for public good—aligning academic excellence with sustainable development goals (SDGs).

**References:**

- Yonsei University. (2024). *University Profile and Vision 2030*. <https://www.yonsei.ac.kr>
- QS World University Rankings 2024
- Korean Council for University Education (2023)

**Educational Relevance for SCOPE KOREA 2025 Participants**

The study visit to Yonsei University (Sinchon Campus) offers cross-disciplinary value for students in all four subject tracks of SCOPE KOREA 2025:

- **Medical & Health Sciences**

Exposure to cutting-edge health research, medical innovation initiatives, and potential collaboration with Yonsei University Health System (YUHS)

- **Science, Technology & Engineering**

Insights into ICT, sustainability research, and Korea's smart university transformation

- **Business & Management**

Understanding Korean business education models, startup incubation strategies, and global MBA case studies

- **Social & Educational Studies**

Observation of Korean higher education culture, internationalization strategies, and inclusive learning practices

This visit encourages students to critically explore how leading universities integrate research, education, and societal impact—aligning with the objectives of global academic competency and innovation development.

รอบนานาชาติ | ศึกษาจากมหาวิทยาลัยชั้นนำต่างประเทศ

SEOUL NATIONAL UNIVERSITY

มหาวิทยาลัยแห่งชาติโซล



SCOPE KOREA  
2025

STUDENT CONFERENCE ON PRESENTATION,  
INNOVATION & EVALUATION

4 SEPTEMBER 2025  
OFFICIAL STUDY TOUR, SEOUL, REPUBLIC OF KOREA

ศึกษาดูงานมหาวิทยาลัยต่างประเทศ

มหาวิทยาลัยแห่งชาติโซล SEOUL NATIONAL UNIVERSITY (SNU) ก่อตั้ง  
ในปี 1946 เป็นมหาวิทยาลัยแห่งชาติชั้นนำของเกาหลีใต้ ได้รับการยอมรับว่า  
เป็นสถาบันการศึกษาที่มีคุณภาพสูงที่สุดในประเทศและอยู่ในระดับแนวหน้าของ  
เอเชีย ปัจจุบันมีนักศึกษา 27,000 คน เปิดสอนกว่า 16 วิทยาลัย และมี  
บัณฑิตวิทยาลัยเฉพาะทางหลายแห่ง จุดเด่นของ SNU คือความเป็นเลิศด้าน

## Seoul National University (SNU)

### A National Flagship University and Global Hub of Research and Innovation

Founded in 1946, Seoul National University (SNU) is South Korea's premier national university and consistently ranked as the top institution in the country. Recognized globally for academic excellence, SNU serves as the hub of advanced research, innovation, and intellectual leadership in Asia. The university has produced leading scholars, policymakers, and industry pioneers who have shaped both Korean society and the global knowledge economy.

#### Institutional Profile

- **Established:** 1946
- **Type:** National Research University
- **Location:** Gwanak-gu, Seoul, Republic of Korea
- **Faculties and Colleges:** 16 colleges, 1 graduate school, 10 professional schools
- **Student Body:** Approx. 28,000 students (undergraduate and graduate)
- **International Partnerships:** 700+ institutions worldwide
- **Website:** <https://www.snu.ac.kr>

#### Academic Strengths and Strategic Vision

- **World-class Research and Innovation:** Leading in science, engineering, humanities, social sciences, and medicine.
- **Global Academic Network:** Extensive partnerships with top universities around the world.
- **Knowledge for Society:** Emphasis on innovation that addresses national development and global challenges.

#### References:

- Seoul National University. (2024). *University Profile and Facts*. Retrieved from <https://www.snu.ac.kr>
- QS World University Rankings 2024.
- Korean Council for University Education (KCUE). (2023). *National Universities in Korea*.

#### Educational Relevance for SCOPE KOREA 2025 Participants

Student Conference on Presentation, Innovation & Evaluation : SCOPE KOREA

TechEd Assessment Testing Office

Website : [www.techeducationth.com/index.php/scopekorea/](http://www.techeducationth.com/index.php/scopekorea/)

Tel : +66 2 686 1202 (Office) Fax : +66 2 686 3433

E-mail: [eicd@th-ttis.com](mailto:eicd@th-ttis.com)

- **Medical & Health Sciences:** Exposure to SNU's leadership in biomedical research and public health initiatives.
- **Science, Technology & Engineering:** Learning from world-class research centers in AI, robotics, sustainability, and ICT.
- **Business & Management:** Understanding SNU's role in fostering entrepreneurship and innovation ecosystems.
- **Social & Educational Studies:** Gaining insights into Korea's national education model and policy leadership.



### Ewha Womans University

#### The World's Largest Women's University and a Pioneer of Social Innovation

Established in 1886 by an American missionary, **Ewha Womans University** is the largest women's university in the world and a global symbol of women's empowerment and equal access to education. Ewha is renowned for producing women leaders in academia, politics, culture, and industry. The university also serves as a center of academic innovation with a mission to advance social justice and sustainable development.

#### Institutional Profile

- **Established:** 1886
- **Type:** Private Women's University
- **Location:** Seodaemun-gu, Seoul, Republic of Korea
- **Student Body:** Approx. 25,000 students (undergraduate and graduate)
- **International Programs:** 900+ partner institutions in 78 countries
- **Website:** <https://www.ewha.ac.kr>

#### Academic Strengths and Strategic Vision

- **Leadership in Women's Education:** A trailblazer in empowering women in higher education worldwide.
- **Social Innovation and Equality:** Strong focus on education that addresses societal issues and global equity.
- **Creative Campus Environment:** Internationally acclaimed campus architecture and learning spaces.



## References:

- Ewha Womans University. (2024). *University Introduction and Vision*. Retrieved from <https://www.ewha.ac.kr>
- QS World University Rankings 2024.
- Korean Council for University Education (KCUE). (2023). *Private Universities in Korea*.

## Educational Relevance for SCOPE KOREA 2025 Participants

- **Medical & Health Sciences:** Understanding gender perspectives in medical education and healthcare delivery.
- **Science, Technology & Engineering:** Observing Ewha's initiatives in sustainability, green technology, and women in STEM.
- **Business & Management:** Exploring Ewha's approaches to social entrepreneurship and innovation-driven leadership.
- **Social & Educational Studies:** Learning from Ewha's global leadership in women's empowerment and inclusive education.

## SCOPE KOREA 2025: Study Visit Program

### Connecting Academic Potential with Innovation, Institutions, and Culture

As a vital component of the international round, all participants of SCOPE KOREA 2025 will engage in a curated **Study Visit Program** in Seoul, Republic of Korea. The study visit is designed to enhance participants' academic perspective, foster global citizenship, and provide interdisciplinary exposure aligned with all four subject tracks of the program. The program includes official visits to the following three key locations

#### 1. Asan Medical Center

Asan Medical Center is one of Asia's most advanced and reputable medical institutions, recognized for its leadership in clinical innovation, biomedical research, and smart hospital technology. During the visit, participants will gain insights into:

- Digital transformation in healthcare services and administration
- Advanced medical technologies, including robotic surgery and AI-supported diagnostics
- Health innovation addressing aging society challenges
- Research and development in medical and life sciences

#### 2. Yonsei University (Sinchon Campus)

Yonsei University, founded in 1885, is a leading research-oriented university in South Korea with a strong emphasis on internationalization, interdisciplinary education, and academic innovation. The visit will include:

- Campus tour and academic briefing by the university's international affairs office
- Introduction to global research programs and smart learning environments
- Exploration of innovation-focused academic infrastructure (subject to availability)
- Opportunities to observe Korea's higher education model and student culture

#### 3. Seoul National University (SNU)

Seoul National University, established in 1946, is Korea's top national university and a global hub for research, innovation, and academic leadership. It plays a crucial role in shaping national development and advancing global knowledge. The visit will include:

- Overview of SNU's role as a national flagship university
- Exposure to world-class research in science, engineering, medicine, and social sciences
- Engagement with international programs and global academic networks



- Learning about Korea's national education model and innovation ecosystem

#### 4. Ewha Womans University

Founded in 1886, Ewha Womans University is the largest women's university in the world and a global pioneer of women's education and social innovation. Ewha has produced women leaders across academia, politics, and industry, while driving inclusive education and sustainability. The visit will include:

- Campus tour and introduction to Ewha's historical and global role in women's higher education
- Insights into social innovation and educational programs promoting equality
- Exploration of Ewha's contributions to science, technology, and sustainable development
- Opportunities to understand women's leadership and empowerment in education and society

#### 5. Cultural Learning Site Visit

To complement the academic and institutional learning, participants will visit a cultural or historical landmark in Seoul, such as Gyeongbokgung Palace, Bukchon Hanok Village, or Namsan Seoul Tower. This component of the program is designed to:

- Promote intercultural awareness and respect for heritage
- Explore the evolution of Korean society, values, and national identity
- Encourage cross-disciplinary reflection on the relationship between tradition and modern development

#### Educational Objectives and Outcomes

The Study Visit Program under SCOPE KOREA 2025 aims to achieve the following:

1. Strengthen the integration of theoretical knowledge with real-world applications
2. Foster interdisciplinary insights across health, technology, management, and education
3. Cultivate intercultural understanding and global citizenship competencies
4. Provide participants with academic and professional inspiration for future development

**Note:** The study visit schedule may be subject to change depending on circumstances beyond the control of the organizing office. All proposed destinations have been officially coordinated and preliminarily approved by the respective institutions. However, should any of the hosting organizations withdraw or cancel the visit due to internal or external considerations, the Examination Center reserves the right to substitute the visit with an alternative site of similar educational purpose and relevance. All adjustments will be made to ensure that the academic value and learning outcomes for participants remain aligned with the program's objectives.